

M. 1:1000

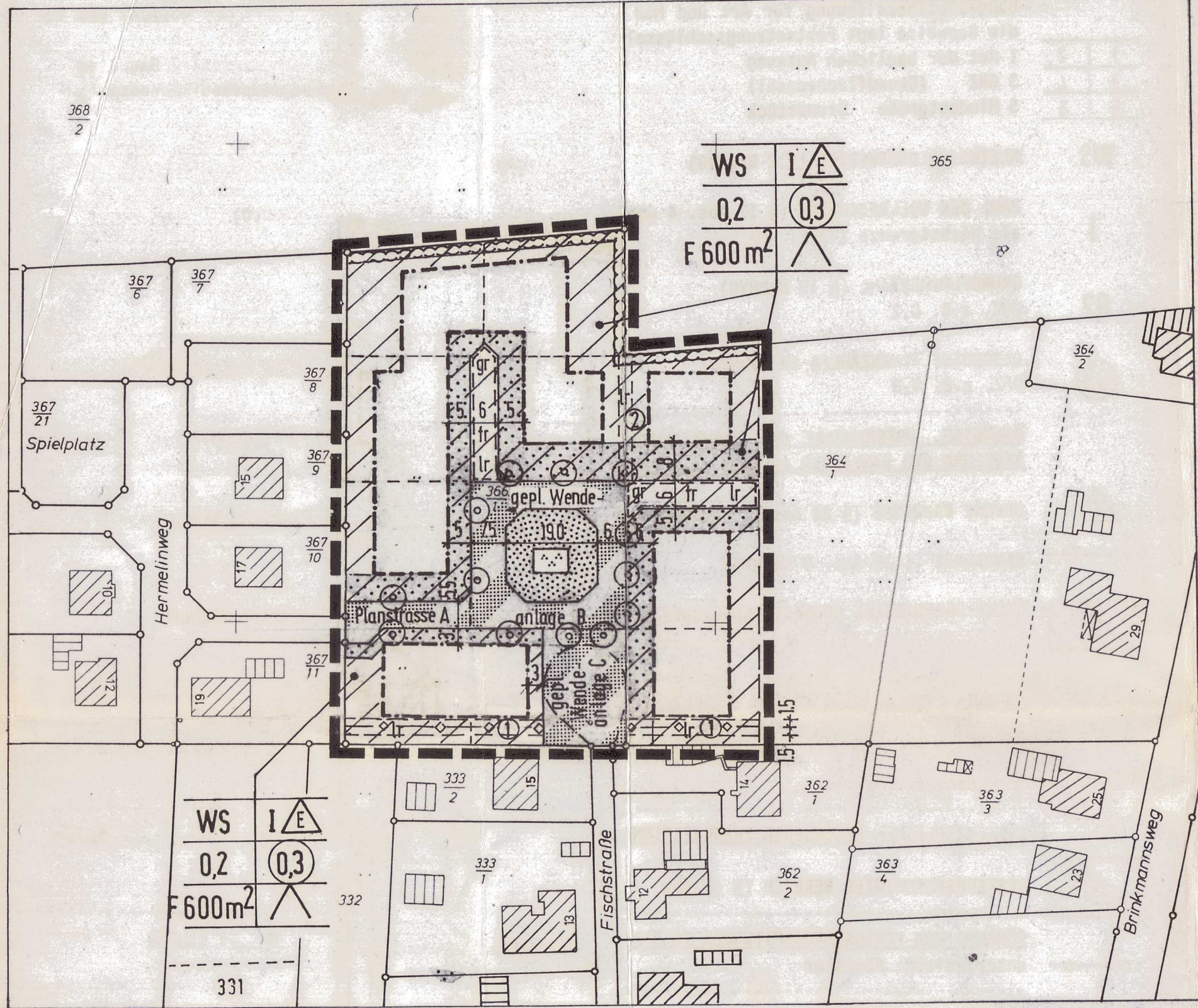

This detailed site plan illustrates the layout of the 'Wendehaus' project. The central focus is a cluster of buildings arranged around a central courtyard labeled 'Wendehaus'. To the left, a 'Spielplatz' (playground) is situated next to a 'Helmweg'. The plan shows various building footprints, some with internal room divisions, and a network of paths and courtyards. Key streets include 'Fischstraße' at the bottom and 'Brinkmannsweg' on the right. Numerous lot numbers (e.g., 367, 366, 365, 364, 363, 362, 333, 332, 331) and area measurements (e.g., 21, 6, 7, 10, 2, 3, 4, 7, 2) are marked throughout the plan. A large arrow points towards the right, indicating a direction of access or flow.
